

4

3

2

1

Revision

REV.	DESCRIPTION	DATE	APPROVED
1	Additional Component: Air Intake Box (KL10-032). Revised Part Numbers: LG frame Side Panel (Right) w. Louvers (KL10-013-R2) and (KL10-013K-R2) for kit, Bottom Plate (KL10-025-R2) was (KL10-025).	04/02/2016	FJ
2	Updated Parts List: Air Intake Box (KL10-032-R2) was (KL10-032), LG Frame Side Panel (Right) w. Louvers (KL10-013-R4) and (KL10-013K-R4) for kit, Aluminum Front Cover Kit (KL10-011K-R3) was (KL10-011K-R2)	11/04/2016	FJ

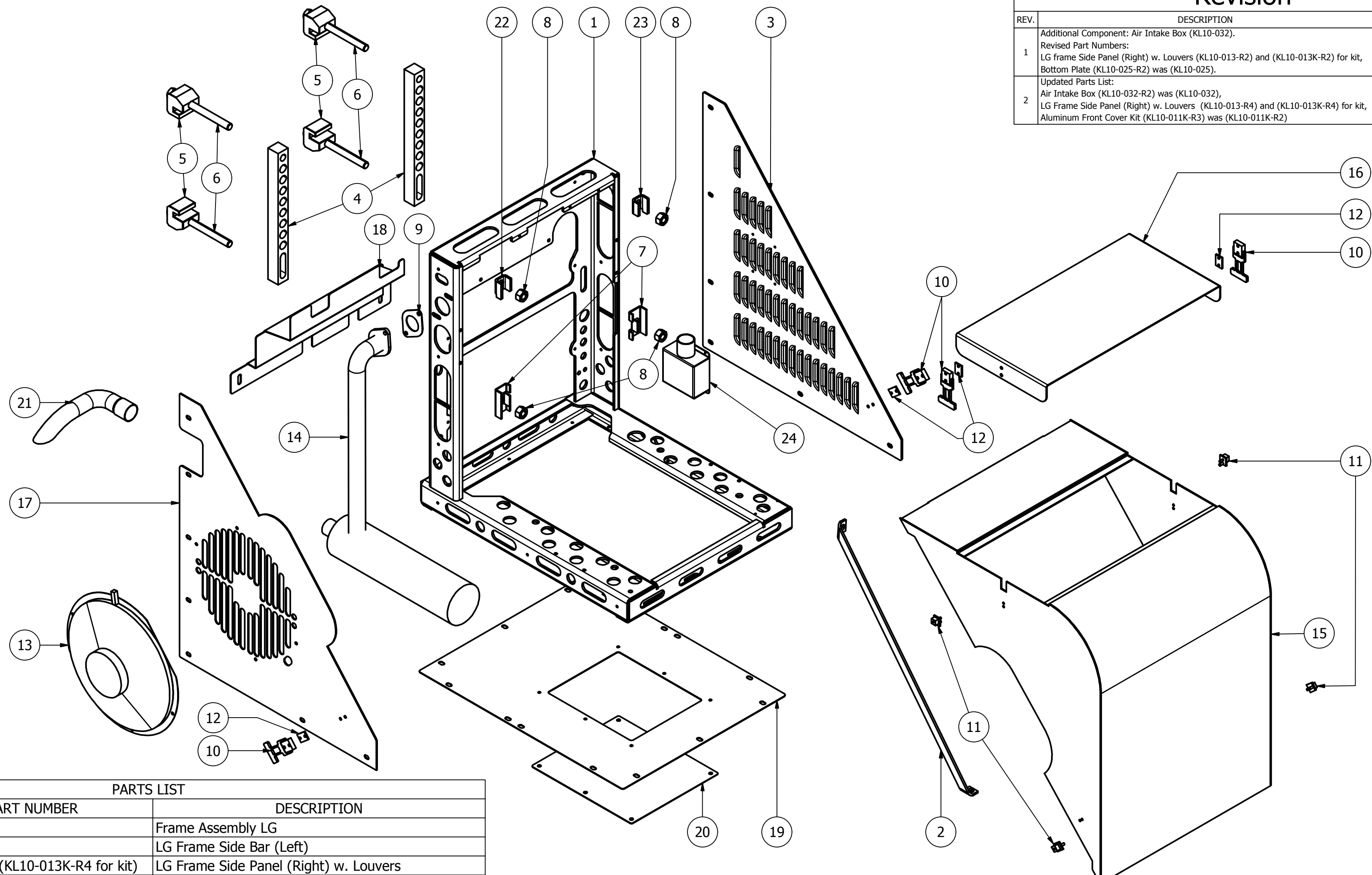

PARTS LIST

ITEM	QTY	PART NUMBER	DESCRIPTION
1	1	KL10-001-R2	Frame Assembly LG
2	1	KL10-002	LG Frame Side Bar (Left)
3	1	KL10-013-R4 (KL10-013K-R4 for kit)	LG Frame Side Panel (Right) w. Louvers
4	2	LG10-004	LG Spacer
5	4	LG10-014	Frame Grabber
6	4	Bolt-001 / LG12-025	HCS 5/8" - 11 UNC - 7 YZ8 Bolt
7	2	LG10-019	Anchor
8	4	Nut-013	5/8" - 11 All Metal Stover "G" Flange Lock Nut Zinc
9	1	RP6-083	Gasket
10	4	RP12-056-L (RP12-056 for both)	Cover Latch
11	4	RP12-056-K (RP12-056 for both)	Cover Latch Clip
12	4	RP10-001-11	Latch Spacer
13	1	LG7-230	12" Electric Fan
14	1	LG6-001	Muffler
15	1	KL10-011K-R3	Aluminum Front Cover Kit
16	1	KL10-014K	Aluminum Front Cover Access Panel Kit
17	1	KL10-012K	LG Frame Side Panel (Left) w. Elec. Fan
18	1	KL10-009-R2	Back Panel
19	1	KL10-025-R2	Bottom Plate
20	1	KL10-026	Bottom Plate Drain Hole Cover
21	1	LG6-010	Exhaust Elbow
22	1	KL10-015	Top Nut Holder (Left)
23	1	KL10-016	Top Nut Holder (Right)
24	1	KL10-032-R2	Air Intake Box

DRAWN Atul	11/04/2016	Rigmaster Power International		
CHECKED Frank	11/04/2016			
QA		TITLE		
MFG		LG Unit Eploded View Outside (Kohler)		
APPROVED		SIZE C	DWG NO LG Unit_Outside R2	REV 2
SCALE		SHEET 1 OF 1		

4

3

2

1